

**LIST OF DRAWINGS**

DRAWING TITLE		
1	S-001	GENERAL NOTES
2	S-001	GENERAL NOTES CONTINUATION
3	S-100	EXISTING FLOOR FRAMING PLANS
4	S-101	PROPOSED FLOOR FRAMING PLANS
5	S-200	DETAILS, SECTIONS AND MAIN ROOF TEMPORARY SHORING PLAN

**SCOPE OF WORK:**

INSTALL TEMPORARY SHORING TO SUPPORT THE MAIN ROOF. REMOVING EXISTING FRAMING AT THE 3RD, 4TH, 5TH AND MAIN ROOF LEVELS. INSTALLING NEW STEEL FRAMING AT THE 3RD, 4TH, 5TH AND MAIN ROOF LEVELS.

**GENERAL NOTES:**

- BUILDING ALTERATIONS WERE DESIGN IN ACCORDANCE WITH APPLICABLE REGULATIONS OF 2022 N.Y.C. BUILDING CODE.
- THE CONTRACTOR SHALL OBTAIN ANY AND ALL PERMITS REQUIRED FOR THE PERFORMANCE OF THE WORK AND PAY ALL FEES IN CONNECTION THEREOF.
- CONTRACTOR SHALL COORDINATE STRUCTURAL DRAWINGS WITH ARCHITECTURAL, MECHANICAL & ELECTRICAL DRAWINGS.
- THE SIZE AND LOCATION OF ALL EQUIPMENT PADS AND PENETRATIONS THROUGH THE STRUCTURE SHALL BE VERIFIED BY THE MECHANICAL, ELECTRICAL AND PLUMBING CONTRACTORS. ALL PENETRATIONS SHALL BE SUBJECT TO APPROVAL BY THE ARCHITECT/ENGINEER.
- CONTRACTOR SHALL CONFORM TO PROJECT SPECIFICATIONS IN ADDITION TO THESE GENERAL NOTES.
- THE CONTRACTOR SHALL NOT MAKE DEVIATIONS FROM DESIGN DRAWINGS WITHOUT WRITTEN APPROVAL FROM THE ARCHITECT/ENGINEER.
- IF THERE IS A DISCREPANCY ON THE CONSTRUCTION DOCUMENTS, THE ARCHITECT / ENGINEER SHALL BE NOTIFIED IMMEDIATELY SO THAT THE DISCREPANCY CAN BE RESOLVED. UNLESS OTHERWISE INDICATED IN WRITING BY THE ARCHITECT/ ENGINEER, THE MORE CONSERVATIVE INTERPRETATION OF THE CONSTRUCTION DOCUMENTS SHALL APPLY.
- DO NOT SCALE DRAWINGS -- WRITTEN DIMENSIONS CONFIRMED BY FIELD CONDITIONS TAKE PRECEDENCE. IF DISCREPANCY ARISES BASED ON FIELD CONDITIONS, CONSULT WITH ARCHITECT/ENGINEER BEFORE PROCEEDING WITH WORK OR ORDERING MATERIALS.
- (\* AFTER ANY DIMENSION OR ELEVATION ON THESE DRAWINGS DENOTES A DIMENSION OR ELEVATION TO BE VERIFIED WITH THE PROJECT ARCHITECT AND CONFIRMED BY THE CONTRACTOR PRIOR TO THE START OF CONSTRUCTION. OTHERWISE THE (\*) DIMENSION OR ELEVATION IS NOT TO BE USED FOR CONSTRUCTION.
- ALL SECTIONS AND DETAILS SHALL BE CONSIDERED TYPICAL AND APPLY FOR THE SAME AND SIMILAR CONDITIONS, UNLESS OTHERWISE SPECIFICALLY NOTED.
- ANY ITEM OF WORK NECESSARY FOR PROPER COMPLETION OF CONSTRUCTION, WHICH IS NOT SPECIFICALLY COVERED ON THE DRAWINGS OR IN THE SPECIFICATIONS, SHALL BE CONSIDERED INCLUDED IN THIS WORK AND SHALL BE PERFORMED IN A MANNER DEEMED GOOD PRACTICE OF THE TRADE INVOLVED.
- THE CONTRACTOR SHALL BE FULLY RESPONSIBLE FOR THE SAFETY OF THE PUBLIC AND PROPERTY DURING CONSTRUCTION OPERATIONS AND UNTIL COMPLETION OF ALL WORK.
- THE CONTRACTOR SHALL BE RESPONSIBLE FOR ADEQUATELY BRACING AND PROTECTING ALL WORK DURING CONSTRUCTION AGAINST DAMAGE, BREAKAGE, COLLAPSE, DISTORTION AND MISALIGNMENT.
- THE CONTRACTOR SHALL BE FULLY RESPONSIBLE FOR "MEANS & METHODS" OF CONSTRUCTION.
- THE ARCHITECT/ENGINEER SHALL NOT BE RESPONSIBLE FOR THE PERFORMANCE OR THE WORK OF THE GENERAL CONTRACTOR, OWNER OR ANY OTHER SUBCONTRACTORS NOR SHALL HE GUARANTEE THEIR PERFORMANCE.
- CONTRACTOR SHALL NOTIFY ARCHITECT IMMEDIATELY IF HE OR SHE CANNOT COMPLY WITH ALL REQUIREMENTS.
- THE ARCHITECT/ENGINEER SHALL NOT BE RESPONSIBLE FOR ANY CHANGES TO THIS PROJECT MADE BY OWNER, GENERAL CONTRACTOR OR ANY SUBCONTRACTOR OR MATERIAL SUPPLIER UNLESS PROPERLY AUTHORIZED, IN WRITING, BY THE ARCHITECT/ENGINEER.

**MISCELLANEOUS NOTES:**

- THESE GENERAL NOTES SUPPLEMENT THE PROJECT SPECIFICATIONS; REFER TO PROJECT SPECIFICATIONS FOR ADDITIONAL REQUIREMENTS.
- STRUCTURAL DRAWINGS ARE INTENDED TO BE USED WITH ARCHITECTURAL AND MECHANICAL DRAWINGS. CONTRACTOR IS RESPONSIBLE FOR COORDINATING SUCH REQUIREMENTS INTO THEIR SHOP DRAWING AND WORK.
- NO OPENINGS SHALL BE MADE IN ANY STRUCTURAL MEMBER WITHOUT THE WRITTEN APPROVAL OF THE ENGINEER.
- NO CHANGE IN SIZE OR DIMENSION OF STRUCTURAL MEMBERS SHALL BE MADE WITHOUT THE WRITTEN APPROVAL OF THE ENGINEER.
- OPENING 1"-4" AND LESS ON A SIDE ARE GENERALLY NOT SHOWN ON THE STRUCTURAL DRAWINGS. REFER TO ARCHITECTURAL AND MECHANICAL DRAWINGS FOR SUCH OPENINGS.
- THE CONTRACTOR IS RESPONSIBLE FOR LIMITING THE AMOUNT OF CONSTRUCTION LOAD IMPOSED UPON STRUCTURAL FRAMING. CONSTRUCTION LOADS SHALL NOT EXCEED THE DESIGN CAPACITY OF THE FRAMING AT THE TIME THE LOADS ARE IMPOSED.
- THE STRUCTURE IS DESIGNED TO FUNCTION AS UNIT UPON COMPLETION. THE CONTRACTOR IS RESPONSIBLE FOR FURNISHING ALL TEMPORARY BRACING AND/OR SUPPORT THAT MAY BE REQUIRED AS THE RESULT OF THE CONTRACTOR'S CONSTRUCTION METHODS AND/OR SEQUENCES.
- DO NOT SCALE THESE DRAWINGS, USE DIMENSIONS. CONSTRUCTION AND/OR ERECTION SEQUENCES SHALL RECOGNIZE AND CONSIDER THE EFFECTS OF THERMAL.
- IN CASES WHERE MATERIAL SHOWN OR SPECIFIED IS NOT READILY AVAILABLE, THE CONTRACTOR MAY PROPOSE THE USE OF ALTERNATE MEMBERS FOR REVIEW BY THE PROJECT MANAGER. THE ALTERNATE MEMBERS PROPOSED MUST PROVIDE THE SAME STRENGTH AND STIFFNESS AS THE ORIGINAL DESIGN CONTRACTOR SHALL BE RESPONSIBLE FOR VERIFYING THAT SUBSTITUTIONS DO NOT INTERFERE WITH ARCHITECTURAL, PLUMBING, MECHANICAL, ELECTRICAL, ETC. REQUIREMENTS OF ANY ADDITIONAL COSTS ASSOCIATED WITH THE PROPOSED SUBSTITUTION SHALL BE BORNE BY THE CONTRACTOR.
- THE CONTRACTOR SHALL INFORM THE ENGINEER IN WRITING OF ANY DEVIATION FROM THE CONTRACT DOCUMENTS. THE CONTRACTOR SHALL NOT BE RELIEVED OF THE RESPONSIBILITY OF SUCH DEVIATION BY THE ENGINEER'S REVIEW OF SHOP DRAWINGS, PRODUCT DATA, ETC. UNLESS THE CONTRACTOR HAS SPECIFICALLY INFORMED THE ENGINEER OF SUCH DEVIATION AT THE TIME OF SUBMISSION. AND THE ENGINEER HAS GIVEN WRITTEN APPROVAL TO THE SPECIFIC DEVIATION.

**EXISTING CONDITIONS NOTES:**

- ALL EXISTING CONDITIONS SHALL BE CHECKED AND VERIFIED IN THE FIELD BEFORE BEGINNING OF WORK. ANY OBSTRUCTION ENCOUNTERED DURING EXCAVATION, DEMOLITION OR CONSTRUCTION, SUCH AS CESSPOOLS, HVAC DUCTS, OTHER UTILITIES, BRIDGING, ETC., SHALL BE REPORTED TO THE ARCHITECT/ENGINEER IMMEDIATELY SO THAT CORRECTIVE MEASURES OR ADJUSTMENTS CAN BE MADE BEFORE CONTINUING WITH WORK.
- THE CONTRACTOR SHALL VERIFY ALL DIMENSIONS BY MEASUREMENTS AT THE JOB SITE AND SHALL TAKE ANY AND ALL MEASUREMENTS NECESSARY TO VERIFY THE DRAWINGS AND TO PERFORM HIS WORK PROPERLY. ANY VARIATIONS FROM THE EXISTING DRAWINGS SHALL BE BROUGHT TO THE ARCHITECT/ENGINEER'S ATTENTION.
- CONTRACTOR SHALL REPAIR/REPLACE ALL CONCRETE, MASONRY AND/OR FIREPROOFING THAT IS REMOVED TO ACCESS EXISTING STEEL.
- GROUT SOLID DIRECTLY UNDER BEAMS BEARING ON NEW AND EXISTING MASONRY.

**DESIGN CODE:**

- BUILDING CONSTRUCTION CODE: 1968 NEW YORK CITY BUILDING CODE AS AMENDED.
- 2022 NEW YORK CITY BUILDING CODE SECTIONS USED WHICH ARE RELATED TO THIS STRUCTURAL APPLICATION:
  - STRUCTURAL (CHAPTER 16)
  - SAFETY DURING CONSTRUCTIONS OPERATIONS (CHAPTER 33)
  - SPECIAL INSPECTIONS (CHAPTER 17)
- ENERGY IS PER NEW YORK CITY ENERGY CONSERVATION CODE (NYECC-2020).
- NATIONAL DESIGN SPECIFICATION (NDS-2018) FOR WOOD CONSTRUCTION WITH 2018 NDS SUPPLEMENT.
- AMERICAN INSTITUTE OF STEEL CONSTRUCTION ("AISC") SPECIFICATION FOR STRUCTURAL STEEL BUILDINGS' AISC 360-16.

**SPECIAL INSPECTION NOTES:**

- PRIOR TO BEGINNING ANY WORK, THE OWNER SHALL RETAIN SERVICES SERVICES OF ACCEPTABLE LICENSED PROFESSIONAL ENGINEER TO PROVIDE INSPECTIONS DURING CONSTRUCTION. THE INSPECTOR SHALL BE QUALIFIED AND APPROVED BY ENGINEER OF RECORD TO PERFORM SPECIAL INSPECTIONS AS REQUIRED BY NYC BC. QUALIFICATIONS SHALL INCLUDE A PROFESSIONAL LIABILITY INSURANCE COVERAGE OF 1 MILLION DOLLARS AND A MINIMUM PROVEN EXPERIENCE OF 5 YEARS WITH SIMILAR WORK.
- SPECIAL INSPECTION SERVICES SHALL BE PROVIDED AS REQ'D BY NYC BC CHAPTER 17 SECTION 1704 BUT NOT LIMITED TO:
  - A. STRUCTURAL COLD-FORMED STEEL BC 1705.2.6
  - B. STRUCTURAL STABILITY - ALTERATIONS OF EXISTING BUILDINGS BC 1705.25.1
  - C. FINAL 28-116.2.4.2, BC 110.5, DIRECTIVE 14 OF 1975, AND 1 RCNY §101-10
- THE SPECIAL INSPECTION ENGINEER SHALL DETERMINE WHETHER CONTINUOUS OR PERIODIC INSPECTIONS ARE NEEDED AND WHETHER HE OR SHE SHOULD INSPECT THE SITE PERSONALLY OR SEND A PERSON UNDER HIS OR HER DIRECT SUPERVISION.
- THE SPECIAL INSPECTION ENGINEER, SHALL MAINTAIN A LOG IN HIS OR HER OFFICE WHICH INCLUDES THE FOLLOWING INFORMATION:
  - (i) ADDRESS OF THE PREMISES, JOB NUMBER, CONTRACTOR'S NAME AND ADDRESS,
  - (ii) DATE AND TIME OF EACH INSPECTION INCLUDING
    - (A) NAMES OF PERSONNEL WHO INSPECTED THE SITE, AND
    - (B) ANY SIGNIFICANT OBSERVATIONS OR INSTRUCTIONS GIVEN RELATING TO ANY OF THE FOLLOWING:
      - (1) DEVIATIONS FROM THE CONTRACT DOCUMENTS.
      - (2) ANTICIPATED FIELD CONDITIONS;
      - (3) PROPER EXECUTION OF THE WORK;
      - (4) GOOD ENGINEERING PRACTICE;
      - (5) SAFE JOB-SITE CONDITIONS;
      - (6) PRECAUTIONS TAKEN TO MAINTAIN SAFE CONDITIONS IF WORK IS STOPPED FOR ANY REASON.
    - (iii) THE DATE OF AND PARTICIPANTS IN ANY CONVERSATIONS WITH THE SPECIAL INSPECTION ENGINEER OCCURRING OFF-SITE AND RELATING TO ANY SIGNIFICANT OBSERVATIONS OR INSTRUCTIONS.
  - THE SPECIAL INSPECTION ENGINEER SHALL RETAIN A COPY OF THE DOCUMENTS DESCRIBED ABOVE IN HIS OR HER OFFICE AND SHALL PROVIDE A COPY TO THE CONTRACTOR AND/OR OWNER TO BE KEPT AT THE CONSTRUCTION SITE.
  - THE SPECIAL INSPECTION ENGINEER RESPONSIBLE FOR SPECIAL INSPECTION SHALL REPORT UNSAFE CONDITIONS TO THE DEPARTMENT OF BUILDINGS AND/OR ANY OTHER AFFECTED PARTIES OR AGENCIES.
  - UPON REQUEST OF THE DEPARTMENT OF BUILDINGS, THE SPECIAL INSPECTION ENGINEER SHALL MAKE AVAILABLE DOCUMENTS AND THE LOG DESCRIBED ABOVE FOR REVIEW BY THE DEPARTMENT OF BUILDINGS

**FIRE SAFETY DURING CONSTRUCTION, ALTERATION AND DEMOLITION**

BC §28-104.8.4  
 2. FIRE SAFETY. ALL NECESSARY LAWS AND CONTROLS, INCLUDING THOSE WITH RESPECT TO OCCUPIED DWELLINGS, AS WELL AS ADDITIONAL SAFETY MEASURES NECESSITATED BY THE CONSTRUCTION SHALL BE STRICTLY OBSERVED.

FC 1401.2 GENERAL.  
 BUILDINGS, STRUCTURES, PREMISES AND FACILITIES UNDERGOING CONSTRUCTION, ALTERATION OR DEMOLITION SHALL COMPLY WITH THE FIRE SAFETY MEASURES SET FORTH IN THIS CHAPTER, AND SHALL ADDITIONALLY COMPLY WITH THE REQUIREMENTS OF NFPA 241 AS TO MEASURES NOT SPECIFICALLY ADDRESSED HEREIN.

ATTENTION CONTRACTORS!
THE DESIGN OF EXISTING BUILDING RENOVATION IS BASED ON PRELIMINARY INVESTIGATION OF EXISTING BUILDING STRUCTURE AND COULD BE CHANGED DUE TO FIELD CONDITIONS.
THE CONTRACTOR MUST NOTIFY ARCHITECT/ENGINEER IF ANY FIELD CONDITION IS NOT IN ACCORDANCE WITH DESIGN DRAWINGS.

**SPECIAL NOTES FOR CONTRACTOR:**

- PRIOR TO BEGINNING ANY WORK, THE CONTRACTOR SHALL RETAIN THE SERVICES OF THE ENGINEER OF RECORD, OR ANOTHER ACCEPTABLE LICENSED PROFESSIONAL ENGINEER WHO SHALL HAVE PROVEN EXPERIENCE ACCEPTABLE TO THE OWNER AND ARCHITECT. MINIMUM REQUIRED QUALIFICATIONS SHALL INCLUDE A PROFESSIONAL LIABILITY INSURANCE COVERAGE OF 1 MILLION DOLLARS AND A MINIMUM PROVEN EXPERIENCE OF 5 YEARS WITH SIMILAR WORK.
- THE CONTRACTOR'S ENGINEER SHALL VISIT THE SITE AND FAMILIARIZE HIMSELF WITH ALL EXISTING CONDITIONS.
- THE ENGINEER SHALL PREPARE PLANS, CALCULATIONS, AND NOTES IN THE FORM OF SHOP DRAWINGS, FOR ALL ITEMS OF WORK WHICH DIFFER FROM WHAT IS SHOWN ON THE STRUCTURAL DRAWINGS DUE TO FIELD CONDITIONS. HE SHALL ALSO PREPARE PLANS IN THE FORM OF SHOP DRAWINGS, CALCULATIONS AND NOTES FOR ALL TEMPORARY SHORES AND BRACES AND CLEARLY INDICATE METHOD OF INSTALLATION, SEQUENCE OF OPERATIONS, AND QUALITY CONTROL.
- THESE SHOP DRAWINGS SHALL BE REVIEWED BY THE ENGINEER OF RECORD AND ARCHITECT PRIOR TO CONSTRUCTION. WORK SHALL BE EXECUTED FROM REVIEWED SHOP DRAWINGS ONLY.
- COPIES OF SUCH DRAWINGS WHICH INCLUDE THE ARCHITECT'S COMMENTS SHALL BE FILED WITH THE DEPARTMENT OF BUILDINGS (ON AMENDMENT FORMS). ADDITIONALLY, AT COMPLETION OF WORK, FORMS INCLUDING ALL INSPECTION REPORTS PREPARED BY THE OWNER'S ENGINEER SHALL BE FILED WITH THE DEPARTMENT OF BUILDINGS.

**COLD-FORMED STEEL NOTES:**

- DESIGN OF COLD FORMED STEEL MEMBERS AND CONNECTIONS ARE IN COMPLIANCE WITH CHAPTER 22 OF THE NEW YORK CITY BUILDING CODE & AISI S240 NORTH AMERICAN STANDARD FOR COLD-FORMED STEEL STRUCTURAL FRAMING.
- ALL STUDS, JOISTS AND ACCESSORIES SHALL BE MANUFACTURED AND INSTALLED IN ACCORDING TO AISI S240 SPECIFICATIONS & CODE OF STANDARD PRACTICE.
- THE G.C. AND WHEN APPLICABLE, THE CONSTRUCTION SUPERINTENDENT, SHALL ENSURE THAT LOADING OF THE COLD-FORMED STEEL FRAMING DOES NOT OCCUR UNTIL THE SPECIAL INSPECTION HAS BEEN PERFORMED AND ANY IDENTIFIED DEFECTS OR INCOMPLETE INSTALLATIONS HAVE BEEN CORRECTED TO THE SATISFACTION OF THE SPECIAL INSPECTOR.
- THE G.C. SHALL NOT ALLOW LOADS FOR WHICH THE DRAWINGS DO NOT ACCOUNT. WHEN INTENDED LOADING, INCLUDING CONCENTRATED LOADING CAUSED BY MATERIAL DELIVERY, EXCEEDS THE LOADING SHOWN ON THE APPROVED DOCUMENTS, THE PERMIT HOLDER MUST PROMPTLY INFORM THE E.O.R. AND PROCEED AS INSTRUCTED. ADDITIONAL INSTRUCTIONS OR DRAWINGS SHALL BE COMMUNICATED TO THE SPECIAL INSPECTOR.
- KEEP THE SPECIAL INSPECTOR AWARE OF THE PROGRESS OF WORK, AND SCHEDULE PERIODIC SPECIAL INSPECTIONS WITH THE SPECIAL INSPECTOR AS INDICATED IN THE BUILDINGS BULLETIN 2019-011. ADMINISTRATIVE CODE §28-116.3.1 REQUIRES THE PERMIT HOLDER TO NOTIFY THE RELEVANT SPECIAL INSPECTION AGENCY IN WRITING AT LEAST 72 HOURS PRIOR TO THE COMMENCEMENT OF ANY WORK THAT REQUIRES A SPECIAL INSPECTION.
- ENSURE THAT ALL WORK REQUIRING SPECIAL INSPECTION REMAINS ACCESSIBLE AND EXPOSED UNTIL THE SPECIAL INSPECTOR APPROVES THE RELEVANT WORK.
- FOR PROJECTS THAT REQUIRE A CONSTRUCTION SUPERINTENDENT IN ACCORDANCE WITH SECTION 3301.13 OF BUILDING CODE, THE G.C. MUST ENSURE THAT THE SUPERINTENDENT IS PERFORMING HIS DUTIES AND FOLLOWING THE PROCEDURES OUTLINED IN THE BUILDINGS BULLETIN 2019-011. IF THE PROJECT DOES NOT REQUIRE A CONSTRUCTION SUPERINTENDENT IN ACCORDANCE WITH SECTION 3301.13 OF THE BUILDING CODE, THE PERMIT HOLDER SHALL ENSURE THE DUTIES SPECIFIED IN ITEMS A THROUGH F OF PART III OF THE BUILDINGS BULLETIN 2019-011 ARE PERFORMED FOR SUCH PROJECT.
- ALL GALVANIZED STUDS 12, 14 AND 16 GAUGE AND ACCESSORIES SHALL BE CONFORM TO ASTM A924 GRADE 'D' WITH A MINIMUM YIELD OF 50,000 PSI. ALL GALVANIZED STUDS 18 & 20, ACCESSORIES AND ALL TRACK SHALL BE CONFORM TO ASTM A924 GRADE 'A' WITH A MINIMUM YIELD OF 33,000 PSI.
- ALL COMPONENTS TO BE ZINC COATED (G60 GALVANIZED) IN ACCORDANCE WITH ASTM C 955.
- TORCH CUTTING OF MEMBERS OR HOLES ARE NOT PERMITTED.
- IF ADDITIONAL HOLES ARE REQUIRED IN THE METAL STUDS OR JOISTS, CONTACT A LICENSED PROFESSIONAL ENGINEER FOR GUIDANCE.
- ALL SCREWS SHALL BE H.W.H STANDARD SELF DRILLING SCREWS U.O.N. ON DWG'S.
  - #10-16 FOR GAGES 20-18
  - #12-14 FOR GAGES 12-16
  - #12-24 WITH DRILL-IN POINT FOR CONNECTIONS TO STRUCTURAL STEEL. (U.O.N.)
- FOR ALL SCREWS THE EDGE DISTANCE SHALL BE 3 TIMES THE NOMINAL DIAMETER, EXCEPT WHERE THE EDGE IS PARALLEL TO THE DIRECTION OF THE APPLIED FORCE THE MINIMUM EDGE DISTANCE OF SCREW FASTENERS SHALL BE 1.5 TIMES THE NOMINAL DIAMETER UNLESS OTHERWISE NOTED ON THE DRAWINGS.
- ALL POWER ACTUATED FASTENERS (P.A.F.) SHALL BE TYPE X-U 0.157" DIAMETER AND MANUFACTURED BY HILTI UNLESS OTHERWISE NOTED ON THE DRAWINGS. THE FOLLOWING EDGE DISTANCE AND FASTENER SPACING TO BE PROVIDED:
 

	CONCRETE	STEEL
EDGE DISTANCE	2 1/4"	1 1/2"
FASTENER SPACING	2 1/4"	1"
PENETRATION	FULL	1/2" (MIN)
- SUBMIT SHOP DRAWINGS FOR APPROVAL BEFORE FABRICATION.

**SUBMITTALS:**

- SUBMITTAL LIST AND SCHEDULE  
 THE GENERAL CONTRACTOR SHALL PREPARE A DETAILED LIST AND SCHEDULE OF ALL SUBMITTAL ITEMS TO BE SENT TO THE STRUCTURAL ENGINEER PRIOR TO THE START OF CONSTRUCTION. THIS LIST SHALL BE UPDATED AND REVISED AND KEPT CURRENT AS THE JOB PROGRESSES. THE SUBMITTAL LIST SHALL BE ORGANIZED AS SHOWN BELOW:
  - a. MANUFACTURER'S LITERATURE FOR PRODUCTS, ASSEMBLIES, AND HARDWARE;
  - b. PRODUCTS, ASSEMBLIES AND HARDWARE;
  - c. PRODUCT CERTIFICATIONS, MILL CERTIFICATES, AND AFFIDAVITS;
- MANUFACTURER'S LITERATURE:  
 SUBMIT TWO COPIES OF MANUFACTURER'S LITERATURE FOR ALL MATERIALS AND PRODUCTS USED IN CONSTRUCTION ON THE PROJECT.

**NEW YORK CITY ENERGY CONSERVATION CODE 2020:**

- TO THE BEST OF OUR OFFICE'S KNOWLEDGE, BELIEF AND PROFESSIONAL JUDGEMENT, THESE SPECIFICATIONS ARE IN COMPLIANCE WITH THE NEW YORK CITY ENERGY CONSERVATION CODE 2020.

THE DESIGN LOADS FOR THIS BUILDING COMPLY WITH THE PROVISIONS OF THE APPLICABLE 2022 NEW YORK CITY BUILDING CODE.

THE DESIGN LOADS FOR THIS NEW BUILDING COMPLY WITH THE PROVISIONS OF THE APPLICABLE NEW YORK CITY BUILDING CODE AS PER SECTIONS BC 107.7 AND BC 1604.

SAFEGUARDS DURING CONSTRUCTION OR DEMOLITION:  
 THE CONTRACTOR SHALL PROVIDE SAFEGUARDS COMPLYING IN ALL RESPECTS WITH CHAPTER 33 OF THE 2022 NYC BUILDING CODE.

THE FILING IS FOR STRUCTURE (ST) WORK TYPE ONLY. OTHER JOBS FILED IN CONJUNCTION WITH THIS JOB ARE:

TEMPORARY SHORING WORK: M01098599-11

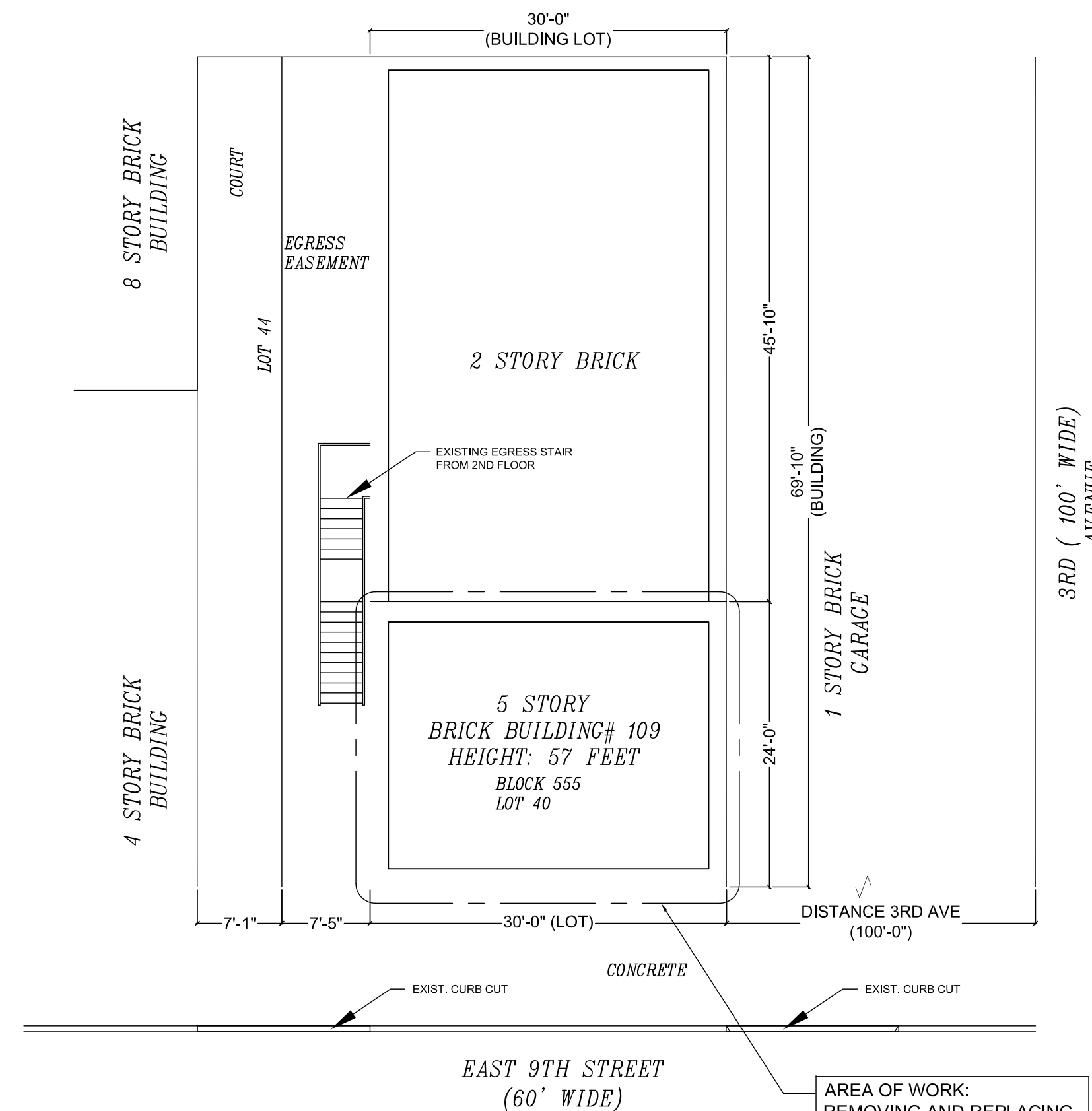

BUILDING INFORMATION			
109 EAST 9 STREET, MANHATTAN, NY 10003			
BLOCK	555	LOT AREA	2,070sf
LOT	40	BUILDING OCCU. CLASS	B-BUSINESS
ZONE	C6-2A	LAND USE	MIXED
MAP	12c	NUMBER OF FLOORS / HEIGHT	5 / 57FT
YEAR BUILT	1900	GROSS FLOOR AREA (ESTIMATED)	7,715sf
CONSTRUCTION CLASS:	3 NON-FIREPROOFED STRUCTURES (OLD CODE)		

**PLOT PLAN**  
 SCALE 3/32" = 1'-0"

AREA OF WORK:  
 REMOVING AND REPLACING EXISTING FRAMING WITH NEW STEEL FRAMING AT THE 3RD, 4TH, 5TH AND MAIN ROOF.

NO.	DATE	REVISION
-----	------	----------

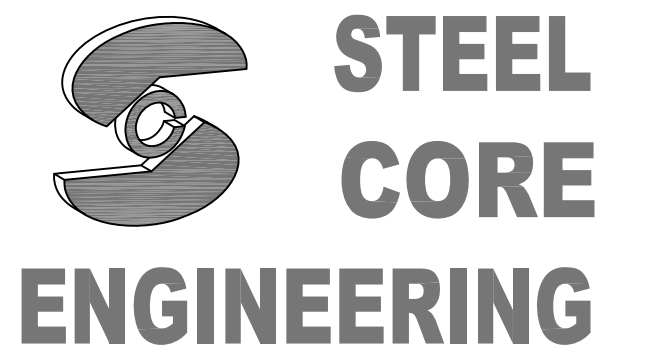

37 WEST END AVE STE. 4E  
 BROOKLYN, NY 11235  
 Tel. 1.347.348.7983  
 e-mail info@steelcoreeng.com

PROJECT:  
 109 EAST 9th ST, NEW YORK, NY 10003

DRAWING TITLE:  
 GENERAL NOTES

STATE OF NEW YORK  
 SEBASTIAN SZTUKOWSKI  
 LICENSED PROFESSIONAL ENGINEER  
 098967

DATE: 01.06.25  
 PROJECT No: 24043  
 SCALE: SEE PLANS  
 PAGE NUMBER: 1 OF 5  
 DWG No: S-001.00

NYC DEPT OF BUILDINGS APPROVAL STAMP:







